

Technical drawing of a vertical assembly, likely a chimney or duct, showing dimensions and labels. The drawing includes a cross-section at the top and a side view below. Dimensions are indicated by blue lines and numbers:

- Top cross-section: 150 (width), 1050 (height), 1000 (height), 100 (width), 900 (width).
- Labels: 13, 14, 15, 7, 4, 100, 900, 1050, 1000, 150.
- Text: "UÓ ÜP ÁÖX ÜÄÜÖD" (repeated), "ØÁ eÜFGÄV EÜT Ä AÄÄ {", "100", "900", "1050", "1000", "150".

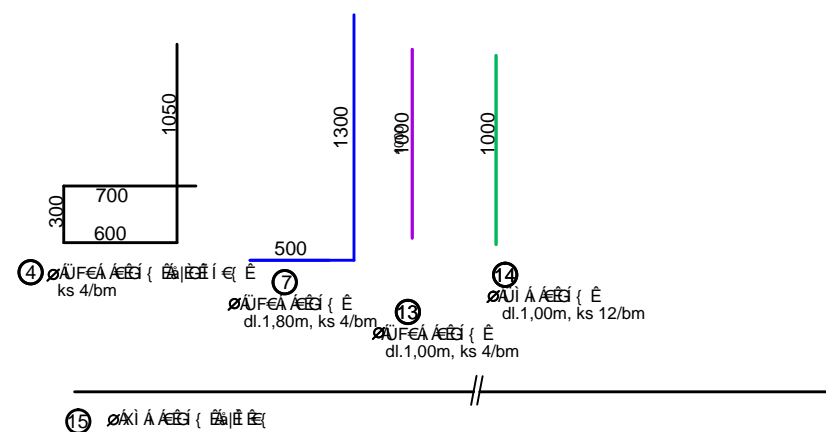

Technical drawing of a vertical assembly, likely a component of a machine. The drawing shows a central vertical shaft or rod passing through a series of components. Key dimensions and labels include:

- Vertical Dimensions (from top to bottom):**
 - 150 (top section)
 - 550 (middle section)
 - 1050 (bottom section)
 - 400 (bottom-most section)
 - 50 (very bottom section)
- Horizontal Dimensions (at the bottom):**
 - 100 (left side)
 - 500 (total width)
 - 100 (right side)
- Labels and Callouts:**
 - SD**: A label on the right side, possibly indicating a standard or specification.
 - 8**, **14**, **15**: Circled numbers indicating specific points or features on the assembly.
 - Ø 16**: A dimension indicating a diameter of 16 units.
 - Ø 14**: A dimension indicating a diameter of 14 units.
 - Ø 12**: A dimension indicating a diameter of 12 units.
 - Ø 10**: A dimension indicating a diameter of 10 units.
 - Ø 8**: A dimension indicating a diameter of 8 units.
 - Ø 6**: A dimension indicating a diameter of 6 units.
 - Ø 4**: A dimension indicating a diameter of 4 units.
 - Ø 2**: A dimension indicating a diameter of 2 units.
 - Ø 1**: A dimension indicating a diameter of 1 unit.

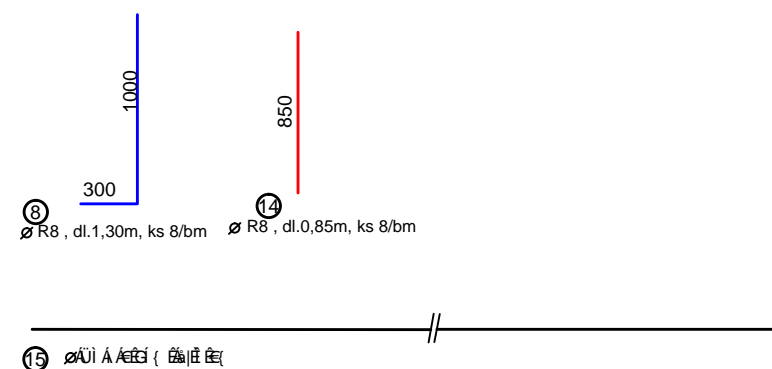
[illegible]